

HOW TO ASSEMBLE AND INSTALL

Fabric Light Boxes

2" and 3" Profiles

INDEX

PAGE1 FRAME ASSEMBLY

PAGE2 MOUNTING

PAGE3 FABRIC INSTALLATION

PAGE4 FINISHED LIGHT BOX

Frame Assembly

STEP 1

Small sizes of this light box come completely assembled. Large sizes come in two or more sections, and are connected by straight connectors.



STEP 2

The LEDs within the light box in large sizes may be in sections that need to be connected by male-female connectors.

In small frames the LED are all connected.

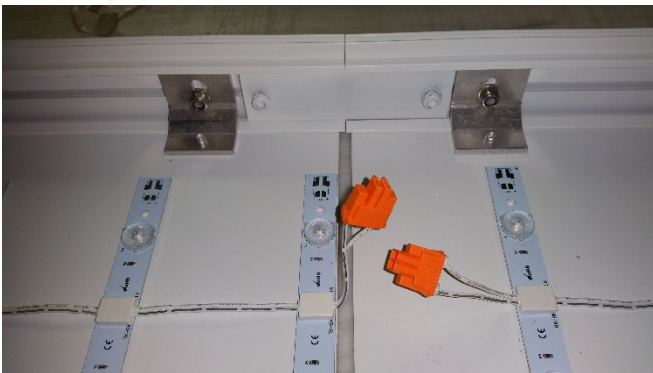

STEP 3

You have ordered your frame with either a plug-in power supply, an internal one or a hardwire one.

Make sure you have planned to install and connect them to the light box.



Mounting

STEP 1

Small light boxes come with a French cleat (Z bar) attached in the back. Install the other cleat that comes with the frame on the wall, and make sure it's leveled. Simply hang the frame on the wall.

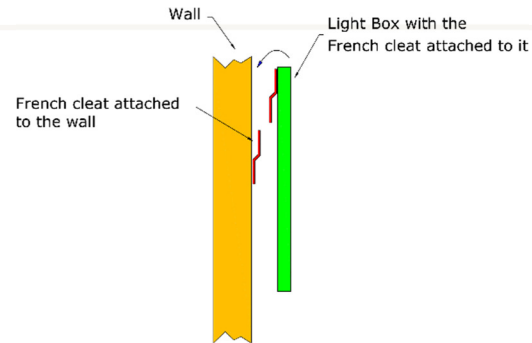

STEP 2

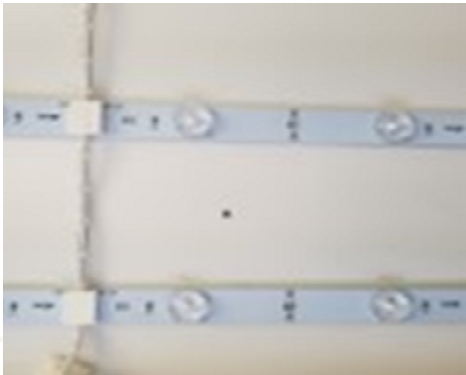

Large frames are simply screwed to the wall. We recommend screwing the frame into the studs in the wall, using the holes on the back plate.

STEP 3

Connect the light box to the power supply:
Plug-in Power Supply: Male-female Connection
Hardwire Power Supply: Hardwire Connection
Internal Power Supply: Standard Power Cord plugged into an outlet

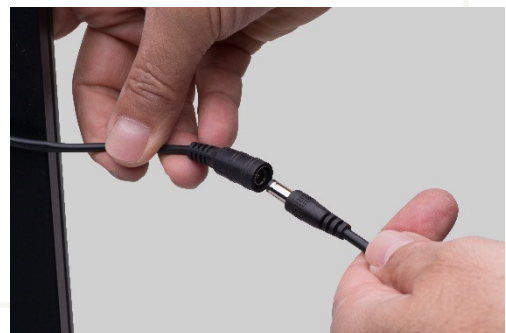

Fabric Installation

STEP 1

Install the light box on the wall.
Insert the silicone edge into the groove in one corner. Then insert the silicone edge into the opposite corner.



STEP 2

Once the corners are in place, begin working on the sides starting at the center. Continue around the frame by inserting the remaining edges until the graphic is taut.



STEP 3

Make sure the silicon edge is all the way into the groove around the frame.

Incomplete →



Installed Fabric Light Boxes



Call or email us for more information:

Tel: 416-269-0447

Email: sales@primelightboxes.com

Brighten Your World

PRIME
Light Boxes