

Installation of Single Sided Snap Frame

The package contains:

- 1 assembled snap frame light box, including a clear acrylic cover
- 1 Pre-Drilled "Z" bar, with screws and wall plugs
- 1 power supply & cord

Step 1: Light boxes must be held vertically to ensure that the frame is not bowed. Improper handling could damage internal parts.

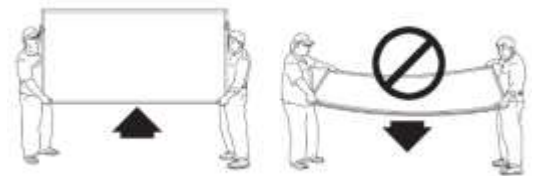

Step 2: Using the screws and wall plugs (included), install the "Z" bar on the wall, and make sure it's leveled.

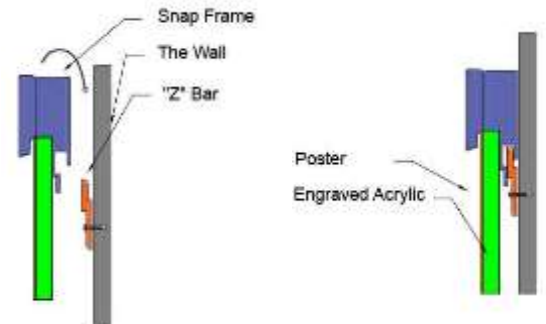

Step 3: Hang the light box on the "Z" bar.

Step 4: Connect to the power supply.

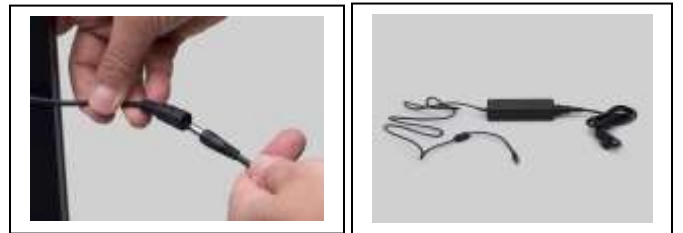

For hanging option by aircraft cables, please contact us.